

WBC for Long Distance Ore and Tailings Slurry Transport

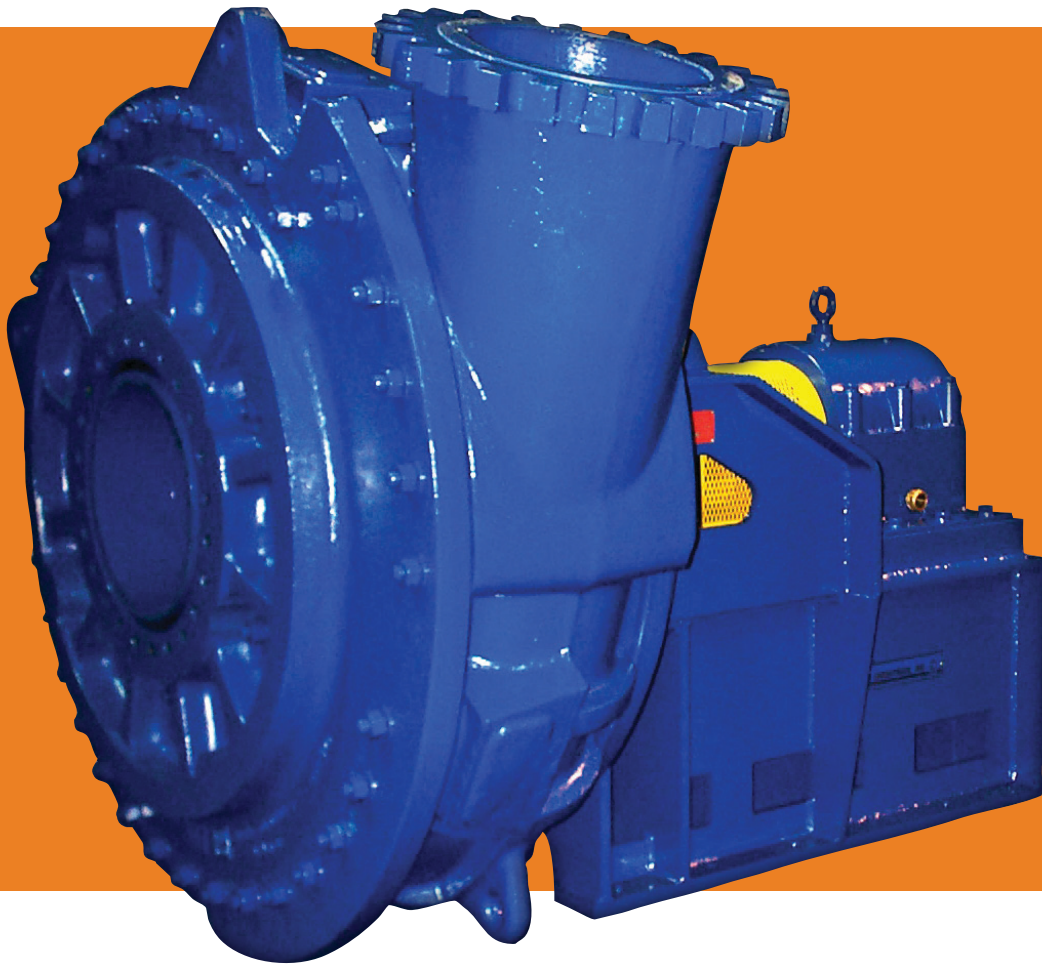

Rock Solid Solutions for Severe Slurries

The WBC pump's patented design incorporates the latest hydraulic and wear technologies for heavy duty, high pressure applications. Its primary service is in ore transport lines that are subject to sudden pressure spikes.

The pump shell is designed to virtually eliminate bending moments and stresses that cause a structural failure during a pressure surge. Non-wearing, ribbed suction and hub plates assist in containing surges, commonly referred to as water

hammer. Design is augmented by the use of rugged GIW Gasite® alloys for superior abrasion resistance.

WBC Slurry Pumps are well suited for severe duties with operating flows up to 70,000 gpm (16,000 m³/h). The design is based on the proven GIW LSA Slurry Pump. WBC pumps may be required when customer specifications exceed the LSA limitations.

**ROCK
SOLID
SOLUTIONS™**

GIW WBC Design Features:

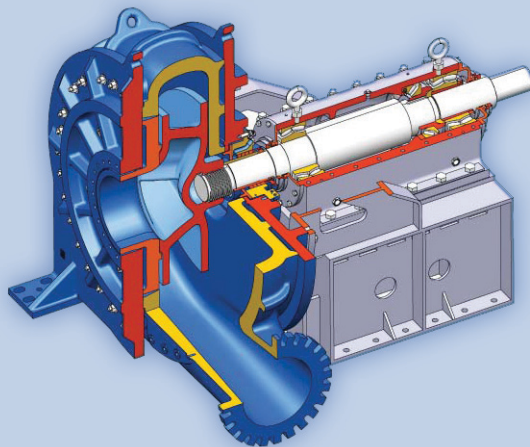

WEAR PARTS

Impeller: Impeller designed for larger sphere passage.

Replaceable Suction Liner: Facilitates pump internal inspection and minimizes wear part usage costs. Liner can be rotated at intervals to increase wear life.

Pump Shell: Computer designed to optimize wear and efficiency and contain sudden pressure surges.

EFFICIENCY

Lower Specific Speed Design: Large diameter impeller allows the pump to run slower for better parts wear life. A lower specific speed also gives the pump the ability to operate over a wide range of flows to meet today's varying flow conditions.

Superior Suction Performance: Designed for excellent Net Positive Suction Head Required (NPSHR) capabilities.

MAINTENANCE FRIENDLY

Impeller Release Ring: Provides for easy impeller removal and is standard on all WBC pumps. The three piece segmented ring is mounted between shaft sleeve and shaft shoulder. Drastically reduces time for wet end change outs for less down time.

MECHANICAL END

Robust stiffened shaft improves wear life of mechanical end. Split-cartridge bearing assembly with Labyrinth seals to protect shaft and bearings. Heavy duty radial bearings are self-aligning. Limited end float design greatly reduces shaft movement.

WBC Offers Wide Selection Range

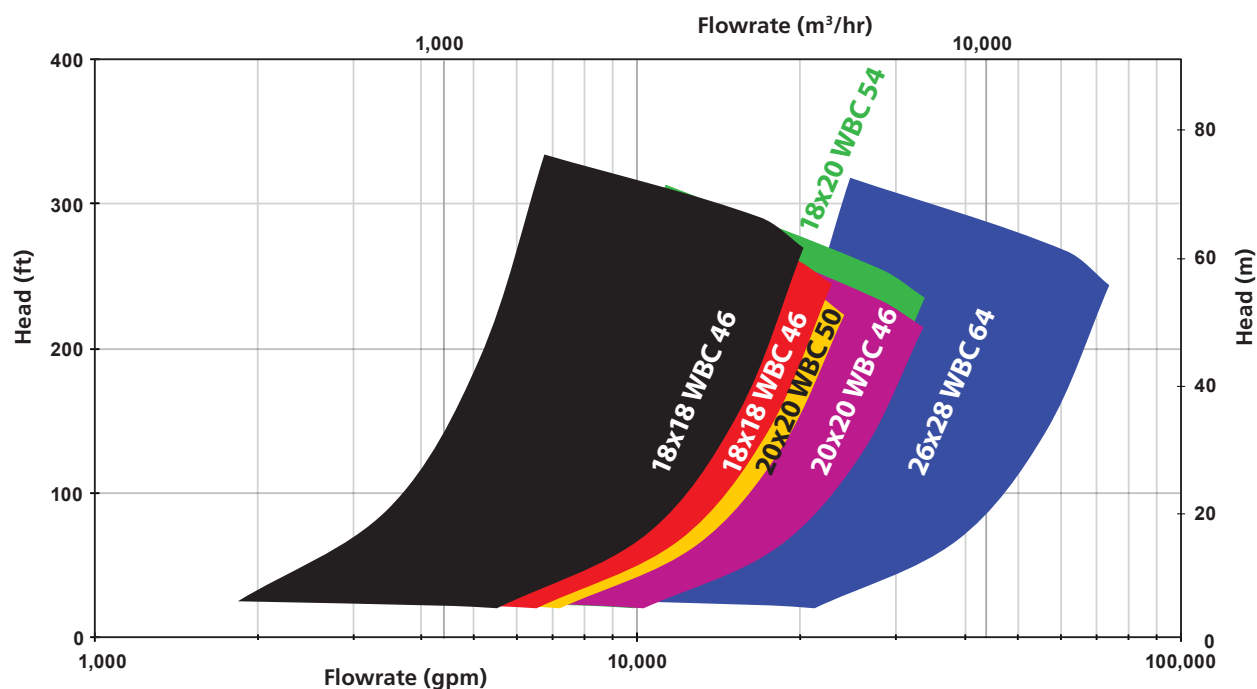

Tried and True Success: Florida Phosphate Industry

- The GIW WBC is heavily used in the Florida Phosphate industry for transport of phosphate ore slurry.
- GIW pumps are the product of choice for major phosphate companies because of their reliability and cost effectiveness.



Applications:

- Phosphate
- Tailings
- Ore slurries
- Hydraulic transport
- Pipeline booster stations

Size Range:

- Discharge diameters: 18 in to 26 in (457 mm to 660 mm)
- Flows to 70,000 gpm (16,000 m³/h)
- Total head: up to 260 ft (80 m)
- Power rating to 8,000 hp (5960 kW)

WBC Shaft Seals

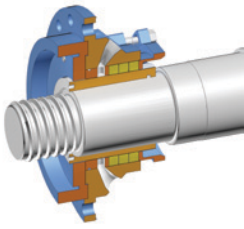

Throat Bushing

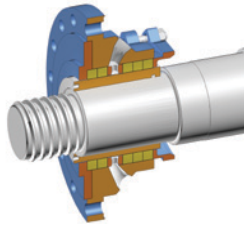

Minimum Dilution

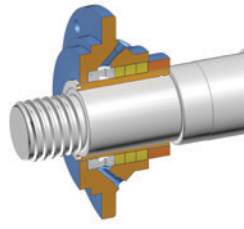

Spiral Trac™

Low Flow Stuffing Box Options

- Match customer needs
- Reduce flow up to 95%
- Maximize water control
- Restrict seal water flow into pump
- Pressure or flow controlled
- Minimize flush water spray
- Improve reliability

WBC Pump Range Information Table

Assembly Number	Nominal Size		Maximum Operating Pressure		Free Passage		Discharge Position	Vane Number & Type	Nominal IMP Diameter
	in	mm	psi	bar	in	mm	degrees		
9600D	18x18-46	450x450-1170	400	28	4.9x6.3	124x161	4 ME	43.75	43.75
9596D	18x18-46	450x450-1170	400	28	8.0x8.8	203x223	3 ME	46	46.00
9655D	18x20-54	450x500-1272	282	19	6.8x8.0	171x203	5ME	54	46.00
9623D	18x20-54	450x500-1272	282	19	8.0x9.8	203x248	3 ME	54	54.00
9515D	18x20-54	450x500-1272	335	23	8.0x9.8	203x248	3 ME	54	54.00
9614D	18x20-54	450x500-1272	400	28	8.0x9.8	203x248	3 ME	54	54.00
9825D	18x20-54	450x500-1272	400	28	8.0x9.8	203x248	3 ME	54	45.00
9829D	18x20-54	450x500-1272	400	28	8.0x9.8	203x248	3 ME	54	49.00
9510D	20x20-46	500x500-1170	400	28	8.4x8.8	213x225	3 ME	45	64.06
9821D	20x20-46	500x500-1170	470	32	7.88x8.0	200x203	3 ME	45	43.75
9811D	20x20-46	500x500-1170	600	41	8.4x8.8	213x225	3 ME	45	46.00
9828D	20x20-50	500x500-1270	333	23	8.5x8.9	216x225	3 ME	49	46.00
9511D	26x28-64	660x700-1625	450	31	9.2x10.9	234x275	5 ME	64.06	54.00
9843D	26x28-64	660x700-1625	450	31	13.5x13.5	343x343	3 ME	67	54.00



GIW INDUSTRIES, INC.

5000 Wrightsboro Rd > Grovetown, Georgia 30813-2842 USA
Telephone (+1) 706-863-1011 > Fax (+1) 706-860-5897

WWW.GIWINDUSTRIES.COM

A KSB Company – **KSB**

**ROCK
SOLID
SOLUTIONS™**

0000.000 / 02.11 / Subject to technical modifications.